

■ IPC Specifications

Spec	1.0M	1.3M	2.0M
Image Sensor	1.0M CMOS	1.3M CMOS	2.0M CMOS
Video compression	H.264 Main Profile		
IR range	10m-50m Optional		
Dual stream	Main 1280x720@30	Main 1280x960@30	Main 1920x1080@30
	Sub 640x360@30	Sub 640x360@30	Sub 720x576@30
Lens	3.6mm 4.0mm 6.0mm 8.0mm 12.0mm Optional		
Min Illumination	0.1Lux/F1.2 (color) , 0 Lux with IR		
Day&Night	IR cut filter with auto switch		
Bit Rate	128Kbps~5Mbps		
Onvif	2.4		
Communication Interface	RJ45 10M/100M self-adaptive Ethernet		
Record mode	NVR, IPclient software		
Power consumption	Max 6W		
Operating Conditions	-20 - + 60°C		
Operating humidity	10 - 85%		

Notice: The power adapter need \geq DC 12V/1A

High Resolution Network IP Camera

User Manual

Quality
Service
Competitiveness



In case of fire or lightning, pls don't put product in damp and raining place, operate or maintain according to the user manual.



Be careful when you see attachment with a Dangerous Voltage which might cause serious electric accident.

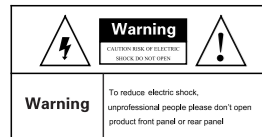

Warning

In case of electric shock and fire, pls don't use power supply beyond power list in user manual

- Notice:**
1. Ensure your equity, pls read the user manual carefully before you use the product
 2. Pls contact professional people if you need install and maintain the product
 3. Input voltage of this model is DC 12V
 4. Working Environment: temperature of -20°C~+60°C, relative humidity under 85%
 5. Pls don't exceed the user manual's standard range of temperature, humidity and voltage.

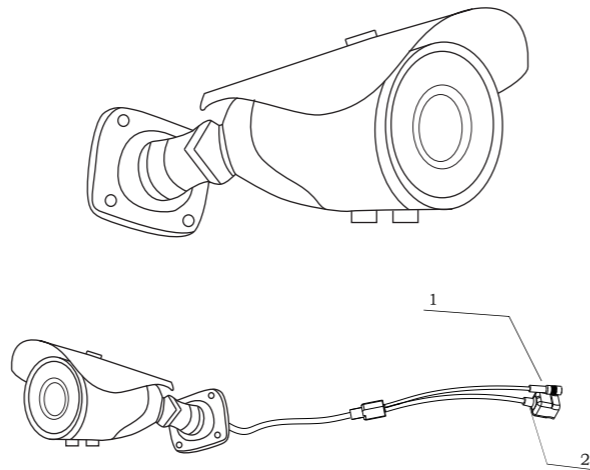

1. DC interface
2. RJ45 interface

External power supply and camera hardware connection

Connect 12V 1A power supply with power interface, plug network wire, wait for about 2 minutes, machine start-up successful.

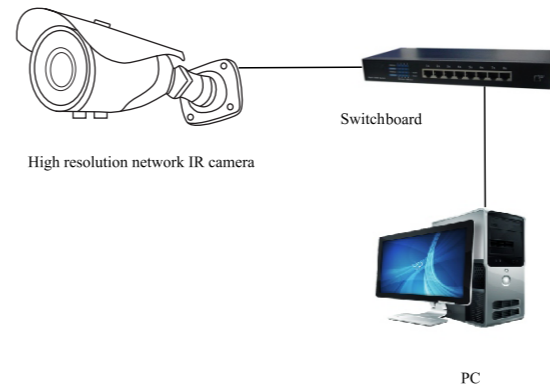

Setting instruction when camera connect with PC

- IE view: Input camera's IP address in IE's address bar, install plugin, then you can view image
- Preview in IPC client: Install client software, click "settings" in software GUI, choose network camera, click "search" button in "network setting", software will automatically search the cameras in Lan, and show the cameras' IP address in "searched IP cameras", double click the IP address, it will automatically add to the form of "connected IP camera", without adding cameras, the GUI can't preview image, click OK, exit preview GUI, camera image will be displayed in 3-5 seconds.

PS: If there is no image, pls disable the firewall in system control panel
 Camera's default IP: 192.168.1.168. User name:
 admin Password: (No password)

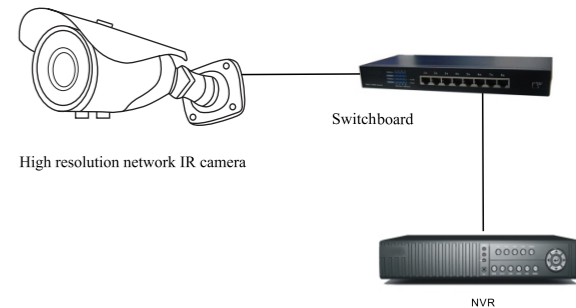

Camera connect with NVR

Click "setting" in NVR main menu, enter IPC setting, click "search" button, system will automatically search cameras in intranet and show the cameras' IP address in the form, double click the IP address, it will automatically append IP to the form of "connected IP camera", without appending cameras, the GUI can't preview image, click enter, camera image will be showed on GUI.